



introduction to trusses

Truss Introduction 1

Architectural Structures I
ENDS 231

Su2004abn

Truss Structures

- comprised of straight members
- geometry with triangles is stable
- loads applied only at pin joints

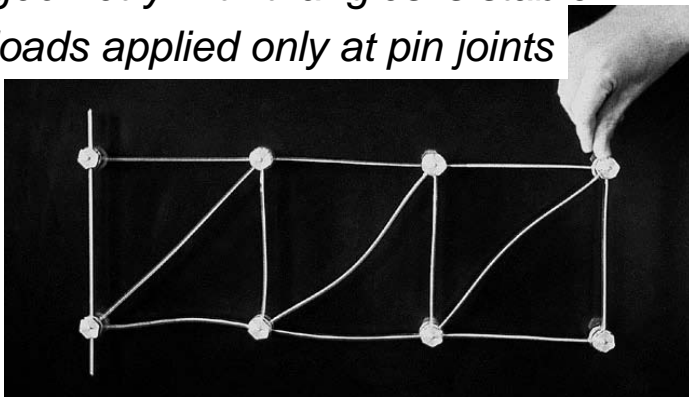

Truss Introduction 8

Architectural Structures I
ENDS 231

S2004abn

Truss Structures

- ancient (?) wood
– Romans 500 B.C.
- Renaissance revival
- 1800's analysis
- efficient



Truss Introduction 7

Architectural Structures I
ENDS 231

S2004abn

Truss Structures

- 2 force members
– compression
– tension

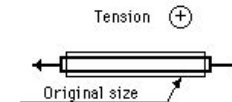

- 3 members connected by 3 joints
- 2 more members need 1 more joint

$$b = 2n - 3$$

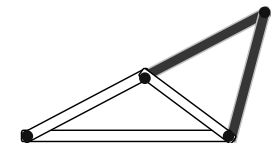

Truss Introduction 9

Architectural Structures I
ENDS 231

S2004abn

Truss Structures

- statically determinate
- indeterminate
- unstable

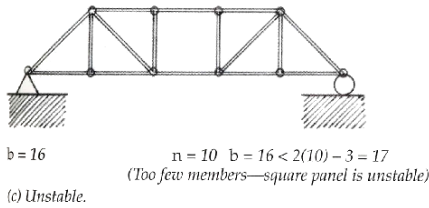
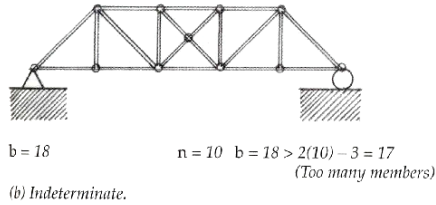
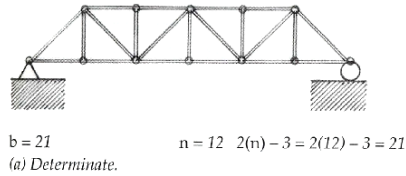

Truss Introduction 10

Architectural Structures I
 ENDS 231

S2004abn

Truss Analysis

- visualize compression and tension from deformed shape

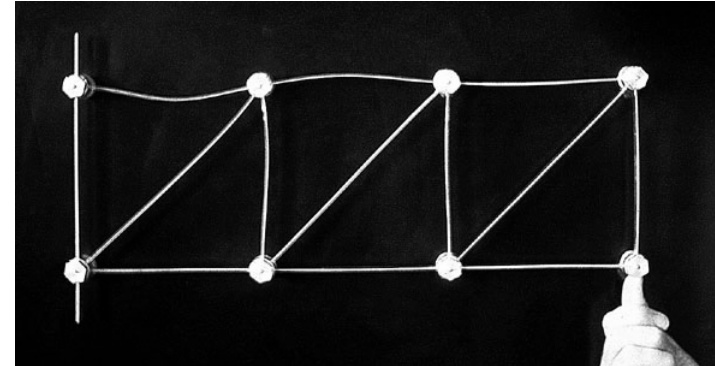

Truss Introduction 11

Architectural Structures I
 ENDS 231

S2004abn

Truss Analysis

- Method of Joints
- Graphical Methods
- Method of Sections
- all rely on equilibrium
 - of bodies
 - internal equilibrium

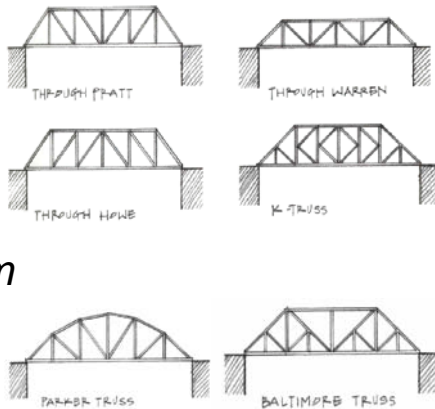

Truss Introduction 12

Architectural Structures I
 ENDS 231

S2004abn

Method of Joints

- isolate each joint
- enforce equilibrium in F_x and F_y
- can find all forces
- long
- easy to mess up

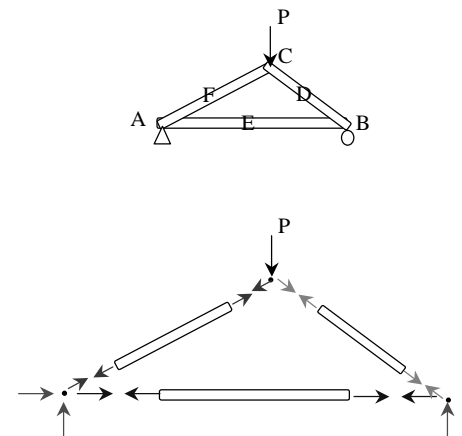

Truss Introduction 13

Architectural Structures I
 ENDS 231

S2004abn

Joint Cases

- two bodies connected

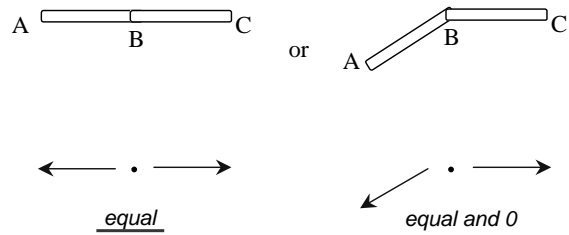

Truss Introduction 14

Architectural Structures I
ENDS 231

S2004abn

Joint Cases

- three bodies with two in line

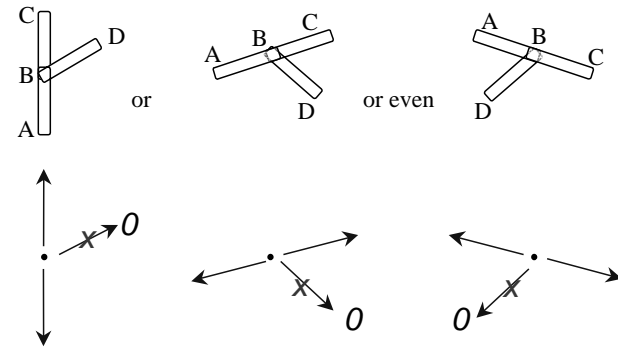

Truss Introduction 15

Architectural Structures I
ENDS 231

S2004abn

Joint Cases

- crossed

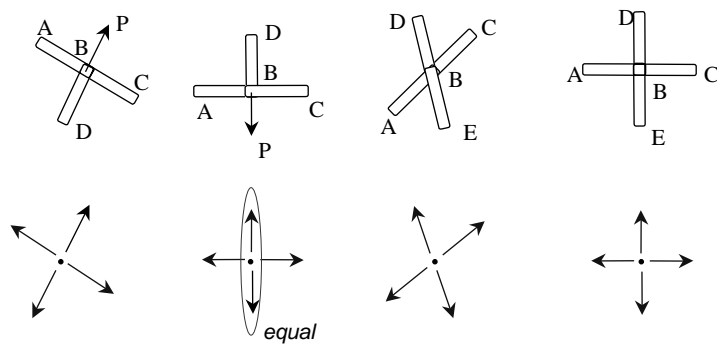

Truss Introduction 16

Architectural Structures I
ENDS 231

S2004abn